

A
B
C
D
E
F

1 2 3 4 5 6 7

Marque Magnetics (2000) LTD
 11 Culperry Rd. Glendene
 Waitakere 0602
 Auckland, New Zealand
 Tel: +64 9 8186760
 Fax: +64 9 8181442

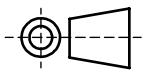

| | NAME | DATE |
|---------------------------------|------|------------|
| CREATE | RL | 15/01/2016 |
| APPRV | LL | 15/01/2016 |
| Note: Pin evenly distributed | | |

| TOLERANCE: | | PART : EI66x25.7 Assembly | |
|--------------|--|-----------------------------|--|
| FRACTIONAL ± | | DESCRIPTION: | |
| X.X ± XX | | | |
| XX.X ± XX | | | |
| XXX.X ± XX | | | |
| Material: | | Scale: 1:1.2 Sheet: A4 Rev: | |
| Size: | | | |
| Weight: | | | |

THE INFORMATION CONTAINED IN THIS DRAWING IS THE SOLE PROPERTY OF MARQUE MAGNETICS 2000 LTD. ANY REPRODUCTION IN PART OR AS A WHOLE WITHOUT THE WRITTEN PERMISSION OF MARQUE MAGNETICS 2000 LTD IS PROHIBITED.