

Marque Magnetics (2000) LTD
 11 Culperry Rd. Glendene
 Waitakere 0602
 Auckland, New Zealand
 Tel: +64 9 8186760
 Fax: +64 9 8181442

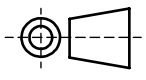

| | NAME | DATE |
|--------|------|------------|
| CREATE | RL | 22/01/2016 |
| APPRV | LL | 22/01/2016 |

Note:
Pin evenly distributed beside pin 1

| | | | |
|--|--|--------------------------------|-----------|
| TOLERANCE: FRACTIONAL ± X.X ± XX XX.X ± XX XXX.X ± XX | | PART : EI48x16 Assembly | |
| Material: | | DESCRIPTION: | |
| Size: | | | |
| Weight: | | | |
| | | Scale: 1:1 | Sheet: A4 |
| | | Rev: | |

THE INFORMATION CONTAINED IN THIS DRAWING IS THE SOLE PROPERTY OF MARQUE MAGNETICS 2000 LTD. ANY REPRODUCTION IN PART OR AS A WHOLE WITHOUT THE WRITTEN PERMISSION OF MARQUE MAGNETICS 2000 LTD IS PROHIBITED.